

# Evidence of Performance

## Airborne sound insulation of building components

### Test Report

No. 15-001589-PR01  
(PB 1-H01-04-en-01)



Client **SAINT-GOBAIN POLSKA Sp.Z.o.o.**  
**ODDZIAL GLASSOLUTIONS**  
ul. Kolejowa 1  
32-312 Jaroszewiec  
Poland

#### Basis

EN ISO 10140-1: 2010  
+A1: 2012 + A2:2014  
EN ISO 10140-2 : 2010  
EN ISO 717-1 : 2013  
Test report no. 15-001589-PR01 (PB1-H01-04-de-01)  
dated 10/07/2015

Product	Insulating glass unit
Designation	SGG Climatop Family Silence
External Dimensions (W x H)	1,230 mm x 1,480 mm
Construction	8 LSG SI / 16 / 4 Float / 16 / 8 Float
Gas filling	Argon
Area related mass	50.2 kg/m <sup>2</sup>
Special features	-/-

#### Representation

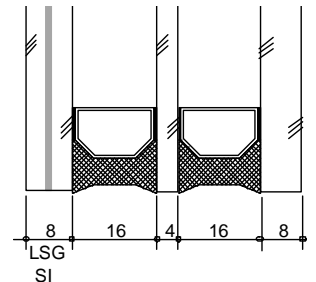

#### Instructions for use

This test report serves to demonstrate the airborne sound insulation of a building component.

Applicable for Germany.

$R_w$  corresponds to  $R_{w,F}$  for DIN 4109, Annex 1, Table 40

#### Validity

The data and results given relate solely to the tested and described specimen.

Testing the sound insulation does not allow any statement to be made on further characteristics of the present construction regarding performance and quality.

#### Notes on publication

The ift-Guidance Sheet "Conditions and Guidance for the Use of ift Test Documents" applies. The cover sheet can be used as abstract.

#### Contents

The test report contains a total of 7 pages:

- 1 Object
  - 2 Procedure
  - 3 Detailed results
  - 4 Instructions for use
- Data sheet (1 page)

Weighted sound reduction index  $R_w$   
Spectrum adaptation terms C and  $C_{tr}$



$$R_w (C; C_{tr}) = 44 (-3; -7) \text{ dB}$$

ift Rosenheim  
10.07.2015

Dr. Joachim Hessinger, Dipl.-Phys.  
Head of Testing Department  
Building Acoustics

Andreas Preuss, Dipl.-Ing. (FH)  
Head of Laboratory  
Building Acoustics

**Airborne sound insulation of building components**

Test Report 15-001589-PR01 (PB 1-H01-04-en-01) dated 10.07.2015

Client SAINT-GOBAIN POLSKA Sp.Z.o.o.

ODDZIAL GLASSOLUTIONS, 32-312 Jaroszewiec (Poland)

**1 Object****1.1 Description of test specimen (All dimensions in mm)**

<b>Component</b>	Insulating glass unit
Product designation	SGG Climatop Family Silence
External dimensions (W x H)	1,230 mm x 1,480 mm
Visible size (W x H)	1,200 mm x 1,450 mm
Total thickness	
On the edge	52.4 mm
In the middle of pane	52.7 mm
Area related mass kg/m <sup>2</sup>	50.2 kg/m <sup>2</sup>
Construction	8 LSG SI / 16 / 4 Float / 16 / 8 Float
Construction of laminated glass	4 mm Float / 0.38 mm Acoustic film / 4 mm Float
Type / Manufacturer of interlayer	Not specified by client
Pane temperature in °C	23 °C
Spacers	Swisspacer Advance
Material	Glass-fiber-reinforced plastic
Manufacturer	Vetrotech Saint-Gobain (International) AG
Edge seals	Two planes, total width 10 mm
External type	Polysulfide (PS)
Manufacturer	Not specified by client
Internal type	Polyisobutylene (PIB)
Manufacturer	Not specified by client
Edge cover	Edge cover 4 mm
Gas filling in cavity	According to analysis at <b>ift</b>
Type of gas	Argon
Volume in %	Cavity I: 96 %, Cavity II: 65 %

The description is based on inspection of the test specimen at **ift** Laboratory for Building Acoustics. Item designations / numbers as well as material specifications were provided by the client.

**1.2 Mounting in test rig**

Test rig	Window test rig with suppressed flanking transmission acc. to EN ISO 10140-5: 2010+A1:2014; the test rig includes a 5 cm continuous acoustic break which is sealed in the test opening with elastic sealant.
Mounting of test specimen	Test specimen mounted by <b>ift</b> Laboratory for Building Acoustics
Mounting conditions	The unit was fitted at a distance of 5 mm into a wooden frame of 25 mm x 25 mm cross section. The cavity between test rig

**Airborne sound insulation of building components**

Test Report 15-001589-PR01 (PB 1-H01-04-en-01) dated 10.07.2015

Client **SAINT-GOBAIN POLSKA Sp.Z.o.o.**  
ODDZIAL GLASSOLUTIONS, 32-312 Jaroszowiec (Poland)

	and glazing beads was completely filled with plastic sealant type Perennator 2001 S grey.
Mounting position	according to EN ISO 10140-1:2010+A1:2012+A2:2014 Annex D
Preparation	Storage of the glazing one day before testing in the test rig for conditioning.

**2 Procedure****2.1 Sampling**

Sampling	The test specimen were selected by the client
Quantity	1
Manufacturer	SAINT-GOBAIN POLSKA Sp.Z.o.o. ODDZIAL GLASSOLUTIONS ul. Szklanych Domow 1 42-530 Dabrowa Gornicza (Poland)
Manufacturing plant , Site of manufacturing	ul. Kolejowa 1 32-312 Jaroszowiec (Poland)
Date of manufacture / date of sampling	15.06.2015
Production line	Not specified by client
Responsible for sampling	Maciej Manko
Delivery at ift	19.06.2015 by the client via forwarding agency
ift Registration Number	39482/01

**2.2 Process****Basis**

EN ISO 10140-1: 2010 + A1: 2012 + A2: 2014	Acoustics; Laboratory measurement of sound insulation of building elements - Part 1: Application rules for specific products (ISO 10140-1: 2010+Amd. 1: 2012+Amd. 2: 2014)
EN ISO 10140-2:2010	Acoustics; Laboratory measurement of sound insulation of building elements - Part 2: Measurement of airborne sound insulation (ISO 10140-2:2010)
EN ISO 717-1: 2013	Acoustics; Rating of sound insulation in buildings and of building elements - Part 1: Airborne sound insulation

Corresponds to the national German standard:

DIN EN ISO 10140-1: 2014-09, DIN EN ISO 10140-2:2010-12 and DIN EN ISO 717-1 : 2013-06

**Airborne sound insulation of building components**

Test Report 15-001589-PR01 (PB 1-H01-04-en-01) dated 10.07.2015

Client

**SAINT-GOBAIN POLSKA Sp.Z.o.o.**

ODDZIAL GLASSOLUTIONS, 32-312 Jaroszewiec (Poland)



Procedure and scope of measurement are in conformity with the principles of the Working Group of sound insulation testing bodies approved by the national building supervisory authorities in cooperation with the standardization committee NA 005-55-75-AA (subcommittee UA 1 - DIN 4109).

Boundary conditions	As required in the standard.
Deviation	There are no deviations from the test procedure and/or test conditions.
Test noise	Pink noise
Measuring filter	One-third-octave band filter
Measurement limits	
Low frequencies	The dimensions of the receiving room full fills the recommended size for testing in the frequency range from 50 Hz to 80 Hz as per EN ISO 10140-4:2010 Annex A (informative). A moving loudspeaker was used.
Background noise level	The background noise level in the receiving room was determined during measurement and the receiving room level $L_2$ corrected by calculation as per EN ISO 10140-4: 2010 Clause 4.3.
Maximum sound insulation	The maximum sound insulation of the test set-up was at least 15 dB higher than the measured sound reduction index of the test specimen. Not corrected by calculation.
Measurement of reverberation time	arithmetical mean: two measurements each of 2 loudspeaker and 3 microphone positions (a total of 12 independent measurements).
Measurement equation A	$A = 0,16 \cdot \frac{V}{T} \text{ m}^2$
Measurement of sound level difference	Minimum of 2 loudspeaker positions and rotating microphones.
Measurement equation R	$R = L_1 - L_2 + 10 \cdot \lg \frac{S}{A} \text{ in dB}$

## KEY

A	Equivalent absorption area in $\text{m}^2$
$L_1$	Sound pressure level source room in dB
$L_2$	Sound pressure level receiving room in dB
R	Sound reduction index in dB
T	Reverberation time in s
V	Volume of receiving room in $\text{m}^3$
S	Testing area of the specimen in $\text{m}^2$

**Airborne sound insulation of building components**

Test Report 15-001589-PR01 (PB 1-H01-04-en-01) dated 10.07.2015

Client **SAINT-GOBAIN POLSKA Sp.Z.o.o.**  
ODDZIAL GLASSOLUTIONS, 32-312 Jaroszowiec (Poland)**2.3 Test equipment**

<b>Device</b>	<b>Type</b>	<b>Manufacturer</b>
Integrating sound meter	Type Nortronic 840	Norsonic-Tippkemper
Microphone preamplifiers	Type 1201	Norsonic-Tippkemper
Microphone unit	Type 1220	Norsonic-Tippkemper
Calibrator	Type 1251	Norsonic-Tippkemper
Dodecahedron loudspeakers	Type 229, 96 Ohm	Norsonic-Tippkemper
Amplifier	Type 235, 100 W	Norsonic-Tippkemper
Rotating microphone boom	Type 231-N-360	Norsonic-Tippkemper

The **ift** Laboratory for Building Acoustics participates in comparative measurements at the Physikalisch-Technische Bundesanstalt (PTB) in Braunschweig every three years, the last one was in April 2013. The sound level meter used, Series No. 24842, was DKD calibrated by the company Norsonic Tippkemper (DKD - Deutscher Kalibrierdienst "German Calibration Service") on 23rd of January 2015.

**2.4 Testing**

Date 30. June 2015  
Operating Testing Officer Dipl.-Ing. (FH) Stefan Bacher

**Airborne sound insulation of building components**

Test Report 15-001589-PR01 (PB 1-H01-04-en-01) dated 10.07.2015

Client

**SAINT-GOBAIN POLSKA Sp.z.o.o.**

ODDZIAŁ GLASSOLUTIONS, 32-312 Jaroszewiec (Poland)



### 3 Detailed results

The values of the measured sound reduction index of the tested Insulating glass unit are plotted as a function of frequency in the annexed data sheet and tabled.

As per EN ISO 717-1 the weighted sound reduction index  $R_w$  and the spectrum adaptation terms  $C$  and  $C_{tr}$  for the frequency range 100 Hz to 3150 Hz obtained by calculation are as follows:

$$R_w (C;C_{tr}) = 44 (-3;-7) \text{ dB}$$

According to EN ISO 717-1 the following additional spectrum adaptation terms are obtained

$C_{50-3,150} = -3 \text{ dB}$	$C_{100-5,000} = -2 \text{ dB}$	$C_{50-5,000} = -2 \text{ dB}$
$C_{tr,50-3,150} = -7 \text{ dB}$	$C_{tr,100-5,000} = -7 \text{ dB}$	$C_{tr,50-5,000} = -7 \text{ dB}$

### 4 Instructions for use

#### 4.1 Test value

Basis

DIN 4109:1989-11

Sound insulation in buildings, requirements and verifications

DIN 4109 Bb11/A1:2003-09

Sound insulation in buildings, examples and calculation methods correction A1

For verification of sound insulation according to DIN 4109, Annex 1 : A1:2003-09, Table 40 the weighted sound reduction index  $R_w$  corresponds to the test value  $R_{w,P, GLASS}$

$$R_{w,P, GLASS} = 44 \text{ dB}$$

#### 4.2 Laminated glass

The sound reduction of laminated glass depends on the temperature of the environment. If the temperature is lower than the test temperature the sound reduction index may be reduced.

#### 4.3 Test standards

The standard series EN ISO 10140:2010 superseded those parts of the standard series EN ISO 140 that were applicable until the respective date and describe laboratory tests. According to the two standard series, the test methods are identical.

ift Rosenheim

Laboratory for Building Acoustics

10.07.2015

# Sound reduction index according to ISO 10140 - 2

Laboratory measurements of airborne sound insulation of building elements



Client: **SAINT-GOBAIN POLSKA Sp.Z.o.o.**  
**ODDZIAL GLASSOLUTIONS**, 32-312 Jaroszewiec (Poland)

Product designation SGG Climatop Family Silence

## Design of test specimen

Insulating glass unit  
 External dimensions 1,230 mm x 1,480 mm  
 Pane configuration 8 LSG SI / 16 / 4 Float / 16 / 8 Float  
 Gas filling in cavity Argon  
 Area related mass 50.2 kg/m<sup>2</sup>  
 Pane temperature 23 °C

Test date 30. June 2015  
 Test surface S 1.25 m x 1.50 m = 1.88 m<sup>2</sup>  
 Test rig as per EN ISO 10140-5  
 Partition wall Double-leaf concrete wall  
 Test noise pink noise  
 Volumes of test rooms V<sub>S</sub> = 109.9 m<sup>3</sup>  
 V<sub>R</sub> = 101.3 m<sup>3</sup>

Maximum sound reduction index  
 R<sub>w,max</sub> = 62 dB (related to test surface)

### Mounting conditions

Glass mounted in test opening and held on both sides by glazing beads (25 mm x 25 mm); gap between test rig, glazing and glazing beads was completely filled with plastic sealant

Climate in test rooms 23 °C / 45 % RH

Static air pressure 966 hPa

f in Hz	R in dB
50	27.1
63	29.4
80	32.1
100	25.2
125	26.6
160	23.6
200	30.8
250	31.2
315	34.2
400	39.2
500	42.5
630	46.0
800	49.3
1,000	50.7
1,250	47.5
1,600	47.1
2,000	50.2
2,500	52.9
3,150	54.4
4,000	60.3
5,000	64.8

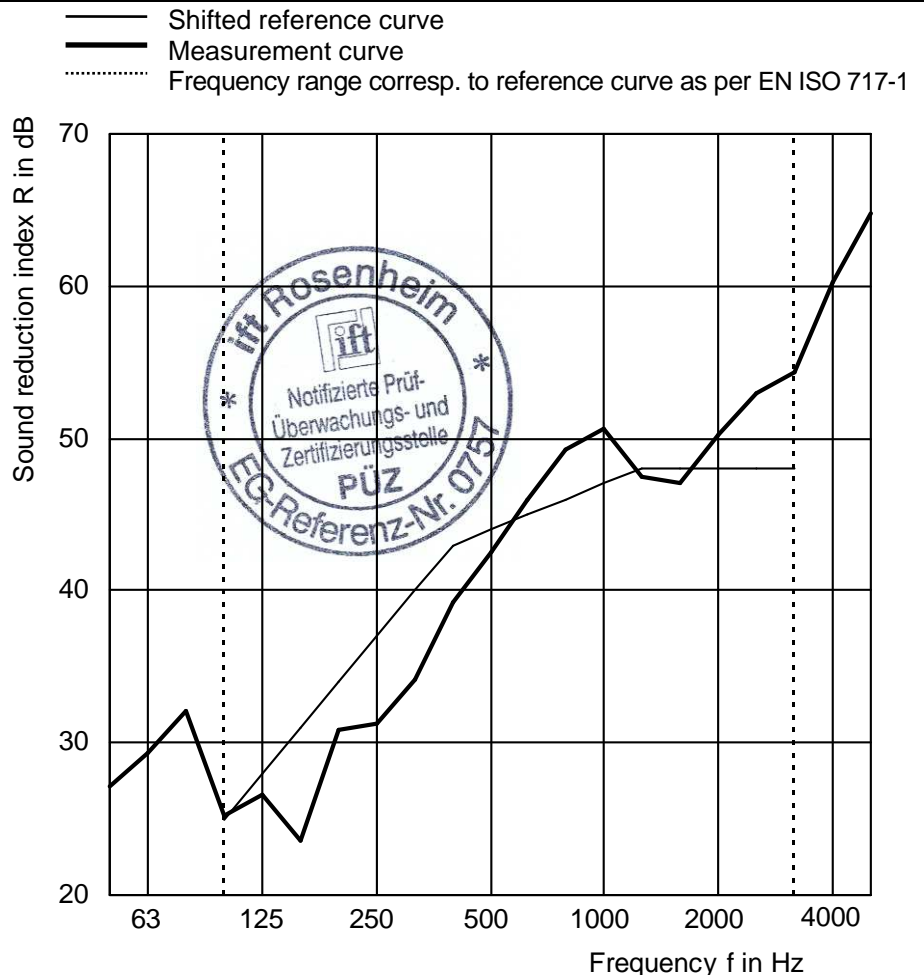

Rating according to EN ISO 717-1 (in third-octave bands):

**R<sub>w</sub> (C;C<sub>tr</sub>) = 44 (-3;-7) dB**    C<sub>50-3,150</sub> = -3 dB; C<sub>100-5,000</sub> = -2 dB; C<sub>50-5,000</sub> = -2 dB  
 C<sub>tr,50-3,150</sub> = -7 dB; C<sub>tr,100-5,000</sub> = -7 dB; C<sub>tr,50-5,000</sub> = -7 dB

Test report No.: 15-001589-PR01 (PB 1-H01-04-en-01)

Page 7 of 7, Data Sheet No. 1

ift Rosenheim  
 Laboratory for Building Acoustics  
 10. July 2015

Dipl. Ing. (FH) Andreas Preuss  
 Head of Laboratory Building Acoustics